

THIS INFORMATION IS CONFIDENTIAL AND IS DISCLOSED TO YOU ON CONDITION THAT NO FURTHER DISCLOSURE IS MADE BY YOU TO OTHER THAN TOP-LINK PERSONNEL WITHOUT WRITTEN AUTHORIZATION FROM TOP-LINK LTD.

DWG NO.
C-101249

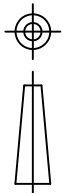

USED ON
-

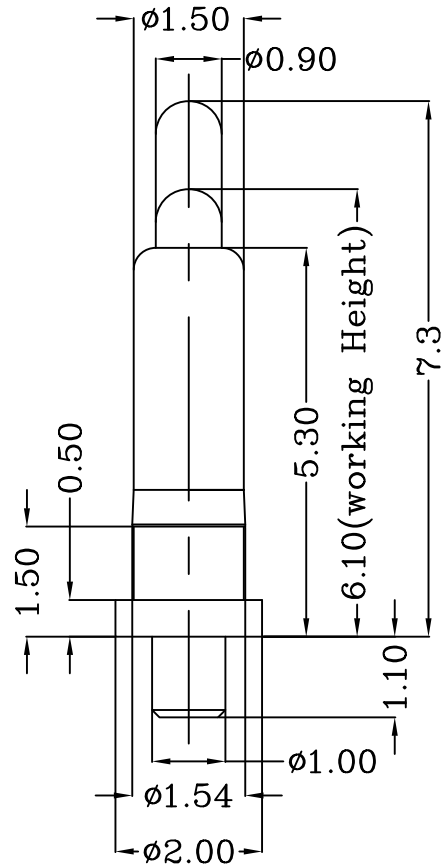

Notes:
 1 Material, Contact: Brass
 2 Mechanical demands:
 Plating Plunger: 0.4Um Au over 1.4um Ni
 Plating Body: 0.1Um Au over 1.4um Ni.

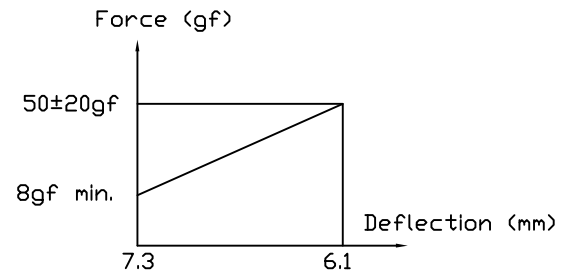

101249-1
PART NUMBER

DIMENSIONS IN MM TOLERANCES UNLESS OTHER SPECIFIED 0 = ±- 0.0 = ±0.15 0.00 = ±0.10 0.000 = ± ANGLE: ±1° SURF TEXTURE: 3.2/▽		MATL △ 1	HT TR -	FIN - ✓
DWN Qln	APVD Lansing			
CHK Jim	REL	Top-Link Electronics Ltd.		
NAME POGO PIN PG-1.0-1.1-2.0-0.5-1.5-5.3-7.3				
SCALE 1:1	A4	DWG NO. C-101249	SHEET 1 OF 1	REV A

LTR	NEW	APVD	DATE 2008/07/29
REVISION RECORD			

LDC	-
DIST	-

4 | | 3 | | 2 | | 1