

THIS INFORMATION IS CONFIDENTIAL AND IS DISCLOSED TO YOU ON CONDITION THAT NO FURTHER DISCLOSURE IS MADE BY YOU TO OTHER THAN TOP-LINK PERSONNEL WITHOUT WRITTEN AUTHORIZATION FROM TOP-LINK LTD.

DWG NO. C-101170

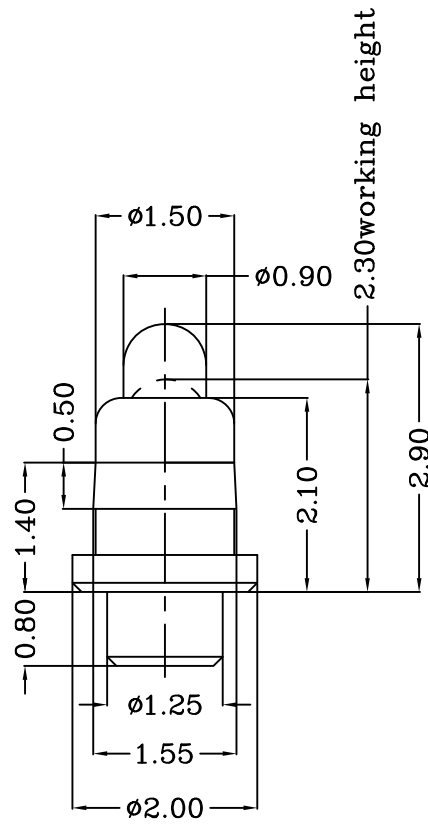

USED ON -



Notes:

- △ Material:
 - 1)Plunger & Body : CuZn36 Pb3, H02 (C36000) or CuZn39 PB3 or CuZn38 PB2.
 - 2)Spring : Stainless steel wire
- 2 Plating
 - 1)Body: Min 0.1um Gold plating over min. 1.4um Nickle plating
 - 2)Plunger: Min 0.4um Gold plating over min. 1.4um Nickle plating
- 3 Mechanical
 - 1)Total stroke : 0.7mm
 - 2)Durability: 10,000 cycle min.
 - 3)Spring Force: 108±22gf .
- 4 Electrical
 - 1)Contact resistance: 30mOhm Max.
 - 2)Operating voltage: 36VDC

LDC	-
DIST	-

	更換彈簧及彈力規格		2008/07/09
	NEW		2008/03/19
LTR	REVISION RECORD	APVD	DATE

DIMENSIONS IN MM
TOLERANCES UNLESS
OTHER SPECIFIED
0 = ±-
0.0 = ±0.15
0.00 = ±0.10
0.000 = ±-
ANGLE: ±1°
SURF TEXTURE: 3.2/
REMOVE BURRS. BREAK
SHARP EDGES R0.05 MAX
DO NOT SCALE PRINT

MATL		△ 1	HT TR		-	FIN		-	✓		
DWN	Qin	APVD	NAME		POGO PIN PG-1.0-0.8-1.5-2.1-2.9						
CHK	REL	SCALE		1:1	A4	DWG NO.	C-101170	SHEET	1 OF 1	REV	B

top-Link Top-Link Electronics Ltd.

101170-1

PART NUMBER