

THIS INFORMATION IS CONFIDENTIAL AND IS DISCLOSED TO YOU ON CONDITION THAT NO FURTHER DISCLOSURE IS MADE BY YOU TO OTHER THAN TOP-LINK PERSONNEL WITHOUT WRITTEN AUTHORIZATION FROM TOP-LINK LTD.

DWG NO.
C-101127

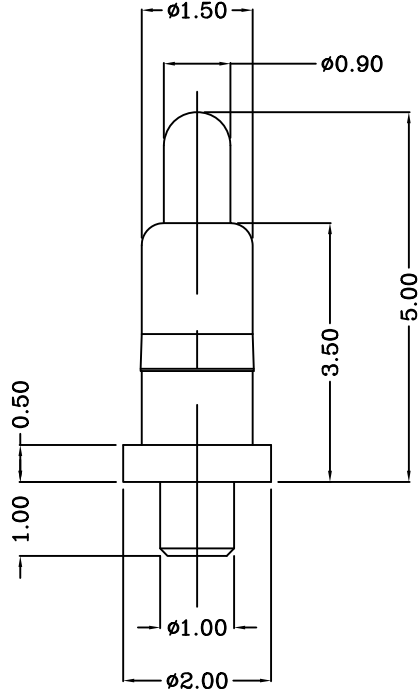

USED ON
—



Notes:

△ Material:

- 1)Plunger & Body : CuZn36 Pb3, H02 (C36000)
or CuZn39 PB3 or CuZn38 PB2.
- 2)Spring : Stainless steel wire
- 2 Plating
 - 1)Body: Min 0.1um Gold plating over min. 1.4um Nickle plating
 - 2)Plunger: Min 0.4um Gold plating over min. 1.4um Nickle plating
- 3 Mechanical
 - 1)Total stroke : 1.3mm
 - 2)Durability: 10,000 cycle min.
- 4 Electrical
 - 1)Contact resistance: 30mOhm Max.
 - 2)Operating voltage: 36VDC

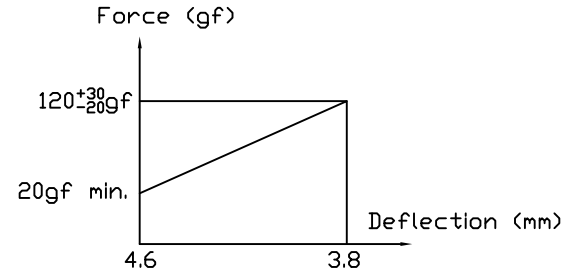

LDC	-
DIST	-

	update		2013/05/07
	New		2007/11/07
LTR	REVISION RECORD	APVD	DATE

DIMENSIONS IN MM
TOLERANCES UNLESS
OTHER SPECIFIED
0 = ±
0.0 = ±0.15
0.00 = ±0.10
0.000 = ±
ANGLE: ±1°
SURF TEXTURE: 3.2/
REMOVE BURRS. BREAK
SHARP EDGES R0.05 MAX
DO NOT SCALE PRINT

MATL △ 1		HT TR —		FIN — ✓	
DWN Benny	APVD Lansing	top-Link Top-Link Electronics Ltd.			
CHK Andy	REL	Electronics			
NAME POGO PIN PG-1.0-1.0-2.0-0.5-1.5-3.5-5.0					
SCALE 1:1	A4	DWG NO. C-101127	SHEET 1 OF 1	REV A.1	

101127-1
PART NUMBER

4

3

2

1