

THIS INFORMATION IS CONFIDENTIAL AND IS DISCLOSED TO YOU ON CONDITION THAT NO FURTHER DISCLOSURE IS MADE BY YOU TO OTHER THAN TOP-LINK PERSONNEL WITHOUT WRITTEN AUTHORIZATION FROM TOP-LINK LTD.

DWG NO. C-100636

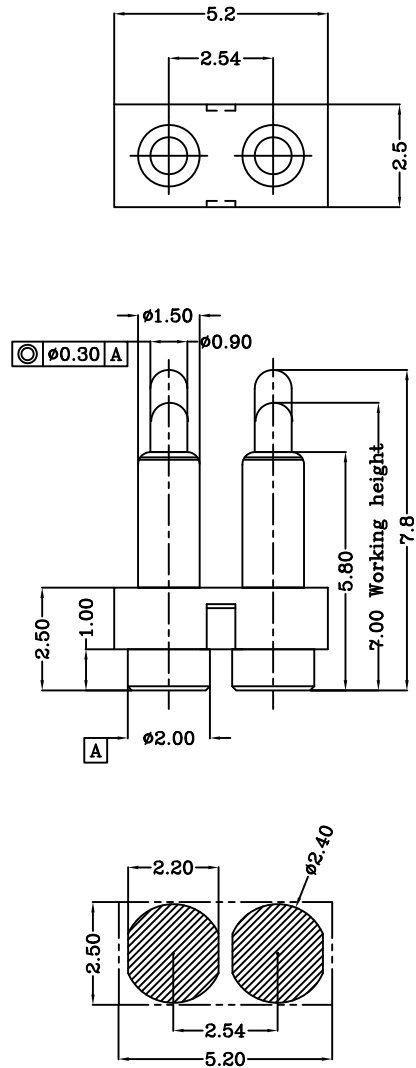

Recommended PCB Layout

USED ON -

Notes:

- 1 Material(材质):
 Housing: PA 4.6 (30% Glass Filled) Color Black.
 Contact: Brass
 Spring :Stainless steel wire
- 2 Plating:
 1)Body: Min 0.1um Gold plating over min. 1.4um Nickel plating
 (Body: 镀金0.1um Min 镍底1.4um Min)
 2)Plunger: Min 0.4um Gold plating over min. 1.4um Nickel plating
 (Plunger: 镀金0.4um Min 镍底1.4um Min)
- 3 Mechanical:
 Force:120±30gf per pin at 0.8mm stroke
 Total stroke(总行程): 1.90mm
 Durability(寿命): 10,000 cycle min.
- 4 Electrical(电性能)
 Contact resistance(接触抵抗): 50mOhm Max.
 Voltage rating(额定电压): 36V DC Max
 Current rating(额定电流): 2.0A

LDC	-
DIST	-

	NEW		2010/08/17
LTR	REVISION RECORD	APVD	DATE

DIMENSIONS IN MM
 TOLERANCES UNLESS
 OTHER SPECIFIED
 0 = ±-
 0.0 = ±0.15
 0.00 = ±0.10
 0.000 = ±
 ANGLE: ±1°
 SURF TEXTURE: 3.2/
 REMOVE BURRS. BREAK
 SHARP EDGES R0.05 MAX
 DO NOT SCALE PRINT

MATL	△ 1	HT TR	-	FIN	- ✓
DWN	Qin	APVD		Top-Link Electronics Ltd.	
CHK	REL				
NAME POGO PIN CONNECTOR 2 POSITIONS PGC-1.5-7.8-R-2P-2.54PH					
SCALE	1:1	A4	DWG NO.	C-100636	SHEET 1 OF 1
					REV A

4

3

2

1

D

C

B

A